



## **Mahogany Wine Rack Assembly Instructions**

**5 & 10 Column Half Height Top Racks  
Estate & Classic Height**



Congratulations! You have purchased the finest wine racking available anywhere. Properly assembled, these solid mahogany Vigilant wine racks will outlast even your finest wines. Please call toll free **888-812-4427** if you have any questions or problems.

**Tools Required:**

- Electric drill or cordless screw gun
- 9/64" drill bit
- Phillips Head Screwdriver
- #2 Square drive bit
- Hammer, preferably rubber or soft-faced

**Note:** If you have chosen your wine rack to be finished without pre-drilled holes, you will need a pneumatic nail gun to properly assemble your rack.

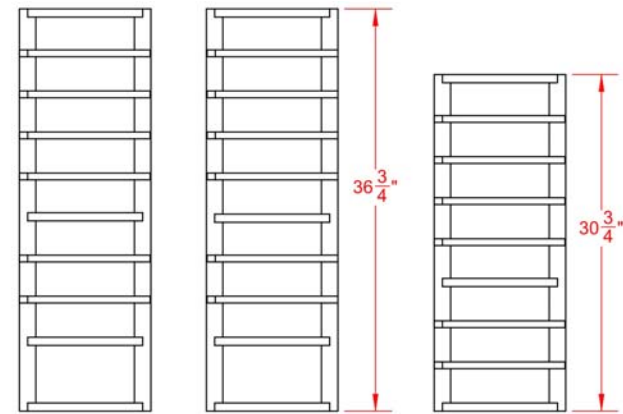

Classic High Reveal Double Ladder

Classic Single Sided Ladder

Classic Double Ladder

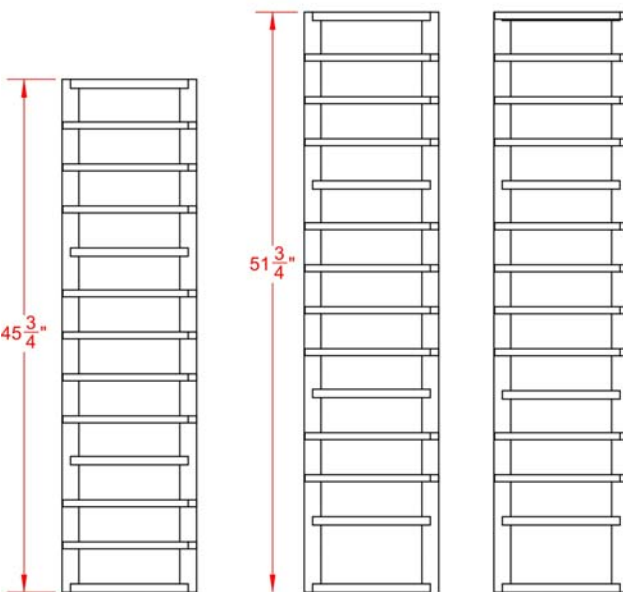

Estate Double Ladder

Estate High Reveal Double Ladder

Estate Single Sided Ladder

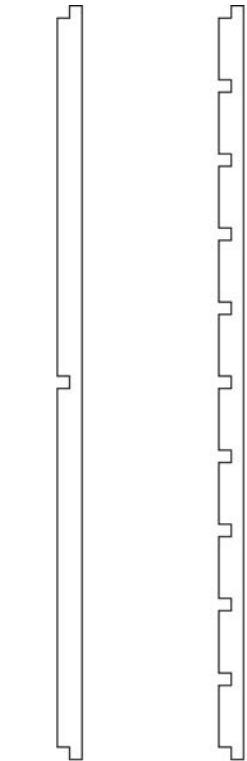

Modified 10 Column Spacer Bar

10 Column Spacer Bar

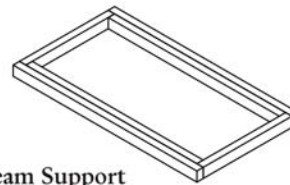

Beam Support

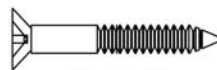

#8 x 1 1/2" Square Head Screw



Screw Head Cap

**Parts**

**Classic Height 10 Column (36.75" high)**

- (1) Left Single Sided Ladder
- (1) Right Single Sided Ladder
- (1) High Reveal Double Ladder
- (8) Double Ladders
- (6) 10 Column Spacer Bars
- (2) Modified 10 Column Spacer Bars
- (2) Beam Supports
- (80) #8 x 1.5" Square Head Screws
- (36) Screw Head Caps

**Estate Height 10 Column (51.75" high)**

- (1) Left Single Sided Ladder
- (1) Right Single Sided Ladder
- (1) High Reveal Double Ladder
- (8) Double Ladders
- (8) 10 Column Spacer Bars
- (2) Modified 10 Column Spacer Bars
- (2) Beam Supports
- (102) #8 x 1.5" Square Head Screws
- (44) Screw Head Caps

**Classic Height 5 Column (36.75" high)**

- (1) Left Single Sided Ladder
- (1) Right Single Sided Ladder
- (4) Double Ladders
- (6) 5 Column Spacer Bars
- (2) Modified 5 Column Spacer Bars
- (1) Beam Supports
- (40) #8 x 1.5" Square Head Screws
- (20) Screw Head Caps

**Estate Height 5 Column (51.75" high)**

- (1) Left Single Sided Ladder
- (1) Right Single Sided Ladder
- (4) Double Ladders
- (8) 5 Column Spacer Bars
- (2) Modified 5 Column Spacer Bars
- (1) Beam Supports
- (52) #8 x 1.5" Square Head Screws
- (26) Screw Head Caps

# Exploded View\*

(Estate Height Shown)

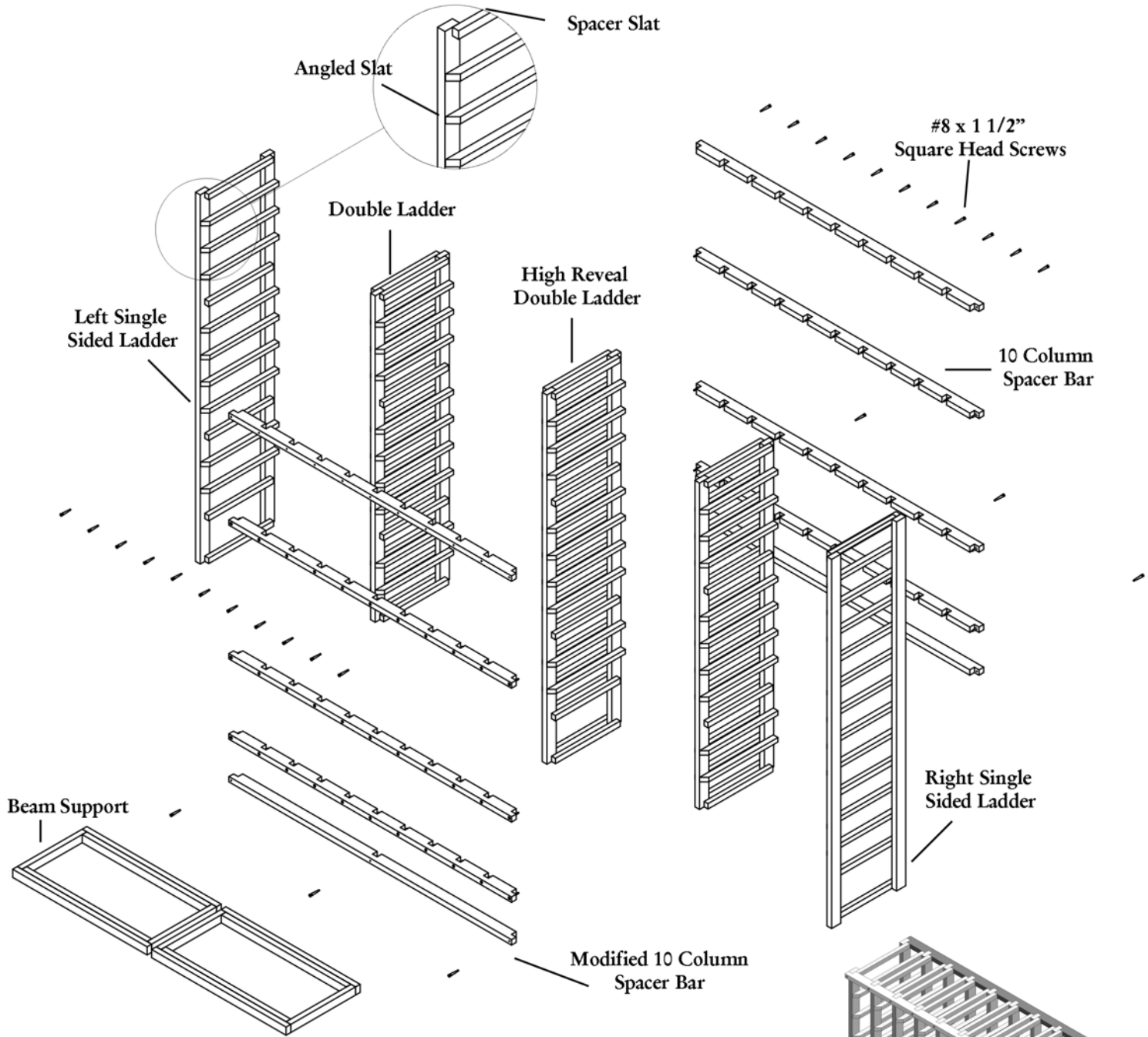

\*Note: A 5 Column Half Height Top Rack will not have a high reveal double ladder in the center of the rack, it will only have one beam support and the spacer bars will be 5 column width.

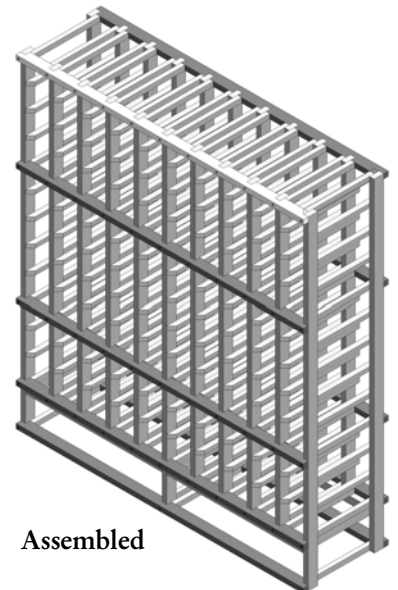

## Steps to Assembly

TAKE NOTE OF DIFFERENCES FOR A 5 COLUMN HALF HEIGHT TOP RACK.

Please see notes in instructions for special steps on assembling racking without pre-drilled holes.

### Step 1

Set the high reveal double-sided ladder with the back on the floor (angled slats facing up) and fit the spacer bar on the front upright of the ladder by placing the dados (or grooves) of the spacer bar onto the upright. (\*\*If you are assembling a 5 Column, use a double-sided ladder on the center dado of the spacer bar for this step.) It may be

necessary to tap the spacer bar lightly with a soft-faced hammer to fit, taking care to align the spacer bar vertically with the spacer slat behind it. \*\*Pre-drill a screw hole through the pre-drilled hole provided in the spacer bar and into the ladder upright using a 9/64" drill bit. Change to the square drive bit and drive a screw into the pre-drilled hole. Be sure that the screw head sinks below the surface.

\*\*Note: For racks without pre-drilled holes, attach spacer bar using nail gun.

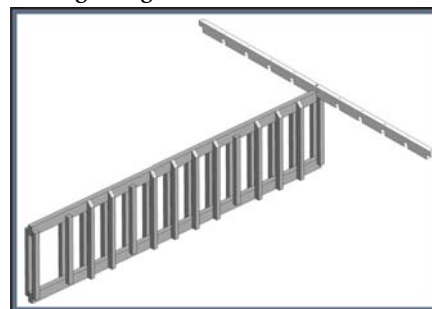
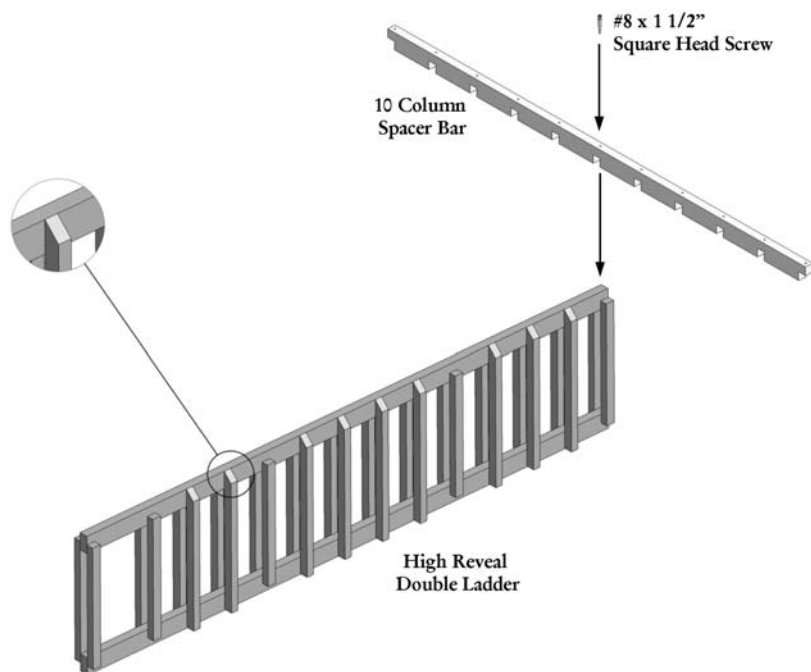

### Step 2

Take a double-sided ladder, set it on its back next to the high reveal double-sided ladder (or double-sided ladder for 5 Column) and slide it into the next open dado (or groove). Align the spacer bar with the spacer slat as before. \*\*Pre-drill through the screw hole and then secure with one of the screws provided. Repeat until all (9)\* double-sided ladders are in place.

\*Note: 4 double-sided ladders for 5 Column

\*\*Note: For racks without pre-drilled holes, attach spacer bar using nail gun.

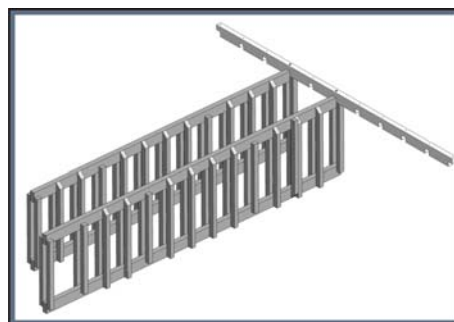
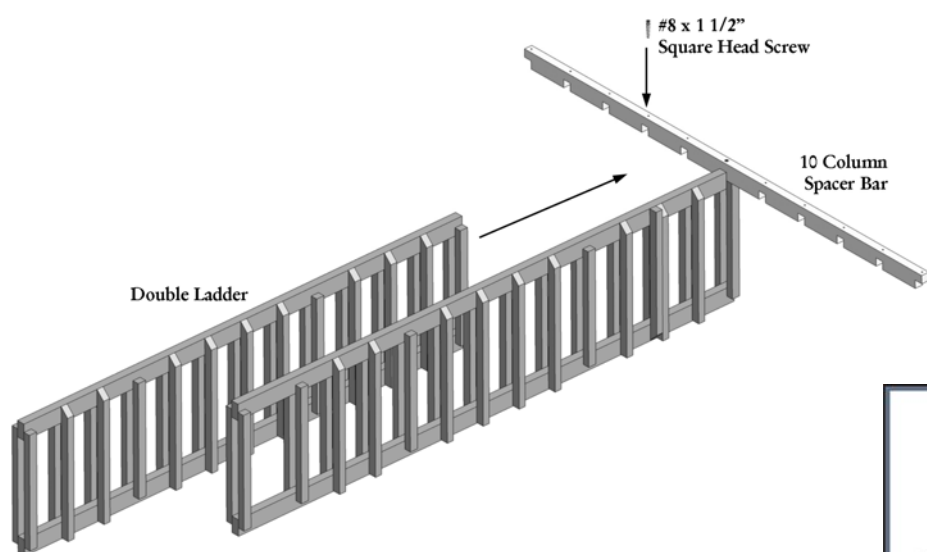

### Step 3

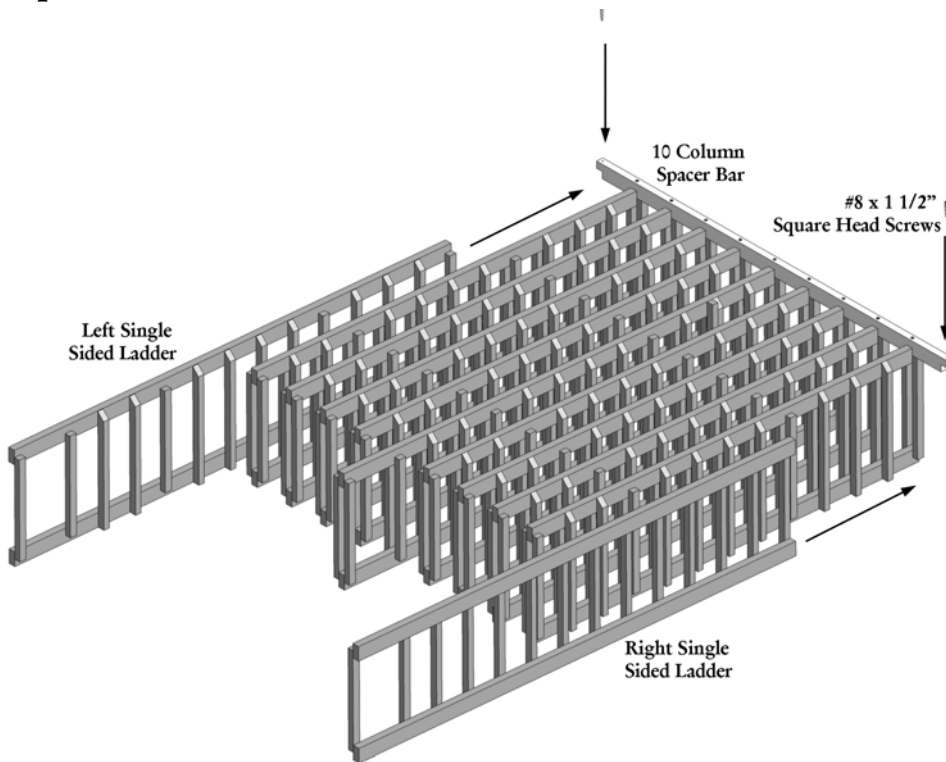

Set the two single-sided ladders with the backs on the floor (angled slats facing up) and into the open end rabbet (or slot) locations. Make sure that the slat sides of the ladders face inward toward the other ladders. Align the spacer bar at the spacer slat location. **\*\*Pre-drill through the existing screw holes on the spacer bar and into the ladder uprights. Secure both ladders with screws as before.**

**\*\*Note: For racks without pre-drilled holes, attach spacer bar using nail gun.**

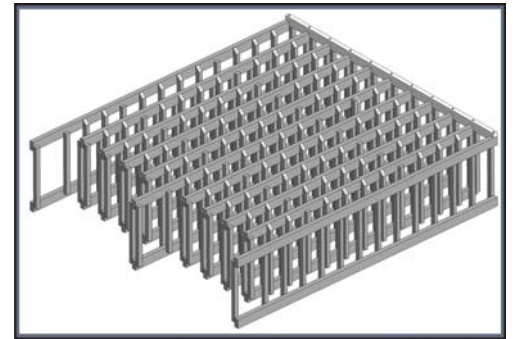

### Step 4

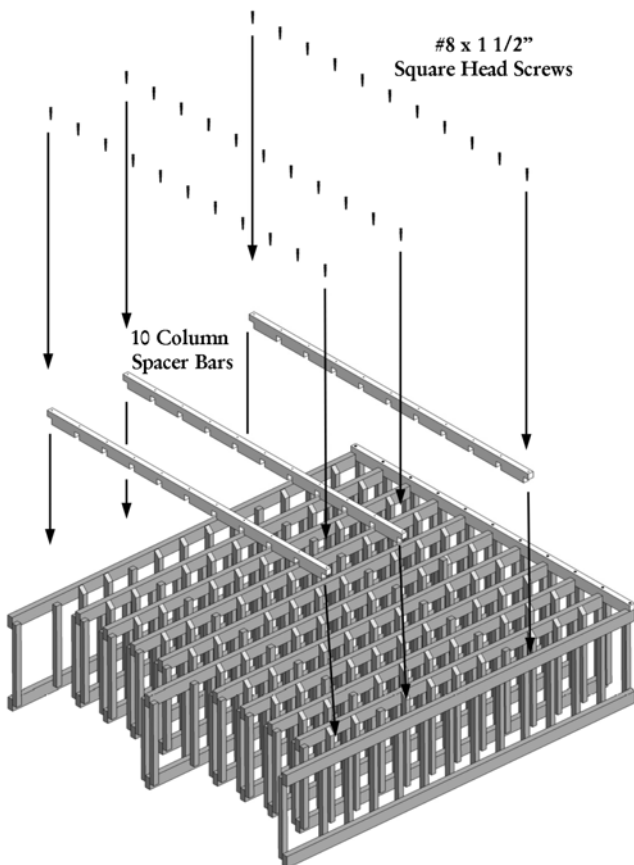

At this point all (11)\* ladders should be attached to the spacer bar. Set another spacer bar over the next spacer slat location, tapping gently with a hammer to ensure a proper fit on all uprights. Align the spacer bar with all the spacer slats behind it. **\*\*Pre-drill through the existing screw holes in the spacer bar and into the uprights. Secure with the screws provided. Continue adding spacer bars, repeating until all front spacer bars have been attached**

**\*Note: 6 ladders for 5 Column**

**\*\*Note: For racks without pre-drilled holes, attach spacer bars using nail gun.**

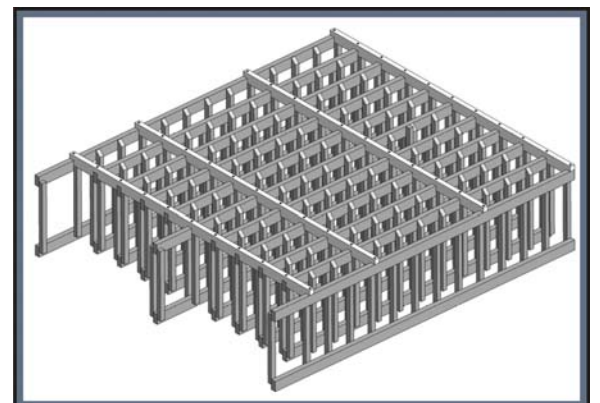

## Step 5

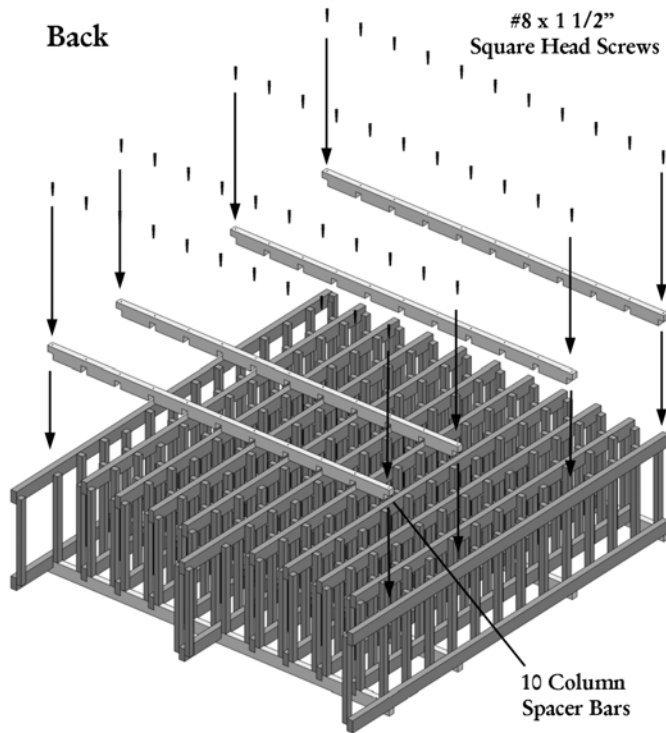

Carefully flip the assembly onto its front. Attach the remaining spacer bars to the back in the same manner as the front. Be sure to align all spacer bars with the spacer slat locations and \*\*pre-drill the screw holes into the uprights before attaching with screws.

\*\*Note: For racks without pre-drilled holes, attach spacer bars using nail gun.

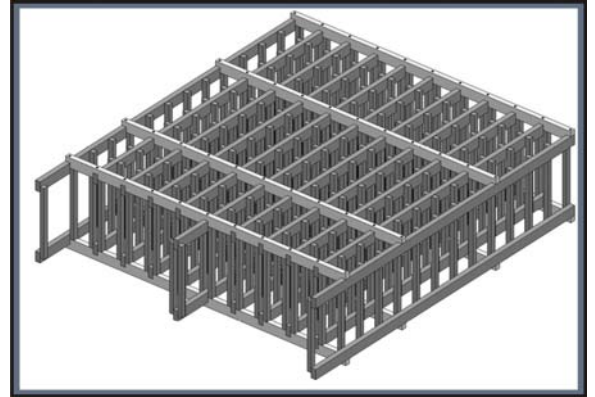

## Step 6

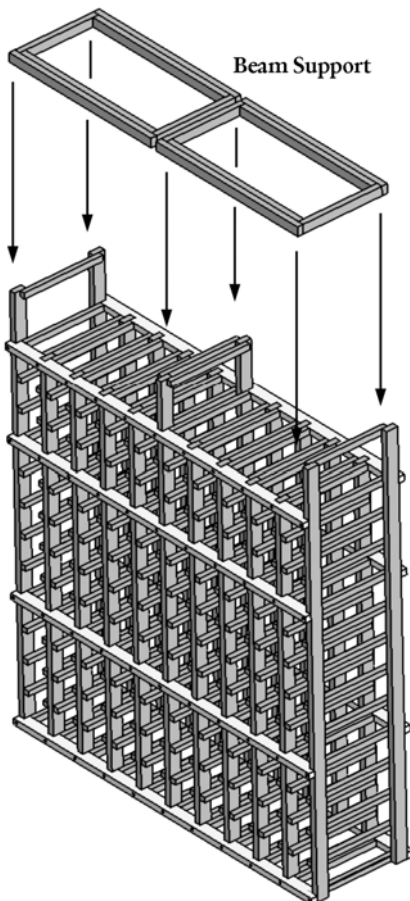

Carefully flip the assembly onto its top, so the assembly is completely upside down. Line the beam support(s) on top, flush with the uprights. Pre-drill and then screw through the four corners of the beam support.

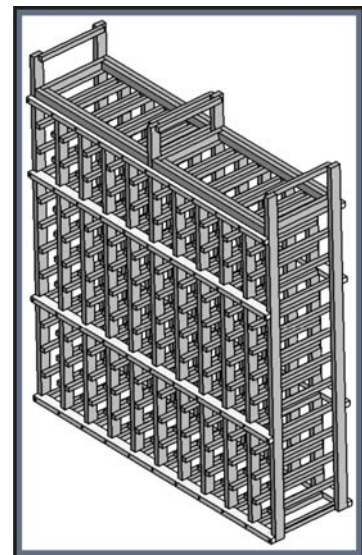

## Step 7

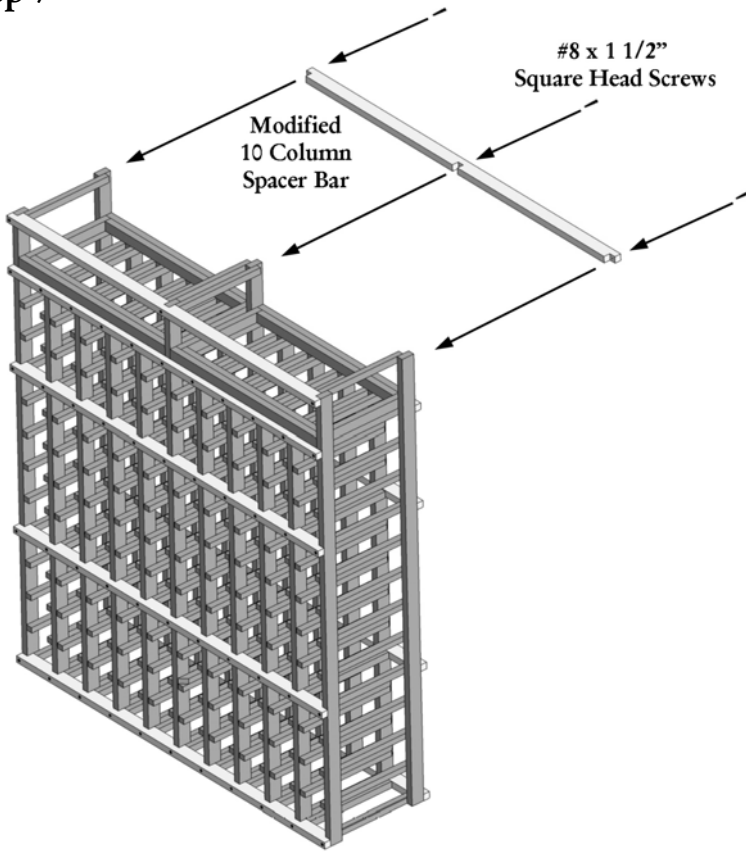

Complete the assembly by attaching the (2) modified spacer bars. Pre-drill then screw into place using the (3)\* pre-drilled holes provided on each spacer bar. The assembly is now complete and ready to be installed.

\*Note: 2 pre-drilled holes for 5 Column.

Note: Attach the half height rack to a half height below by screwing up through the bottom rack into the uprights of the (2) single-sided ladders and the high reveal double ladder.

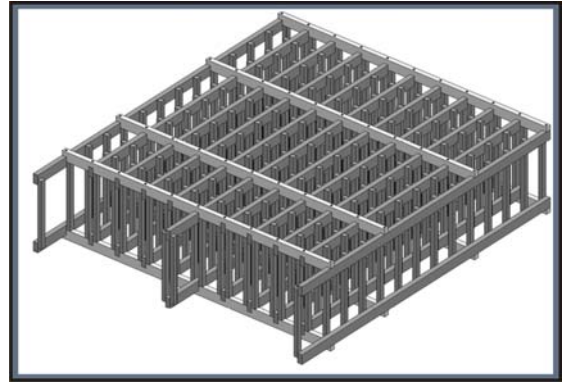

*Additional installation questions?*  
*Contact us:*



VIGILANT, INC.  
85 Industrial Park Drive  
Dover, NH 03820  
Toll Free 1-888-812-4427  
Outside US 1-603-285-0400  
Fax 1-603-285-0420  
email: [info@vigilantinc.com](mailto:info@vigilantinc.com)  
On the web [www.vigilantinc.com](http://www.vigilantinc.com)