



**Wine Rack
Assembly Instructions
Diamond Cube**



Classic Series



Estate Series

Congratulations! You have purchased the finest wine racking available anywhere. Properly assembled, these Vigilant wine racks will outlast even your finest wines. Please call toll free **888-812-4427** if you have any questions or problems.

Tools Required for Assembly:

- Phillips Head Screwdriver
- 9/64" drill bit
- #2 Square drive bit
- Hammer, preferably rubber or soft-faced
- Wood glue (*to be used at all joints*)
- Finish Nails (not provided)
- Hammer for finish nails

Parts List:

Before starting, carefully review the parts and quantities against the parts list to make sure you have everything you need. Then read through the instructions, taking time to familiarize yourself with the pieces and steps.

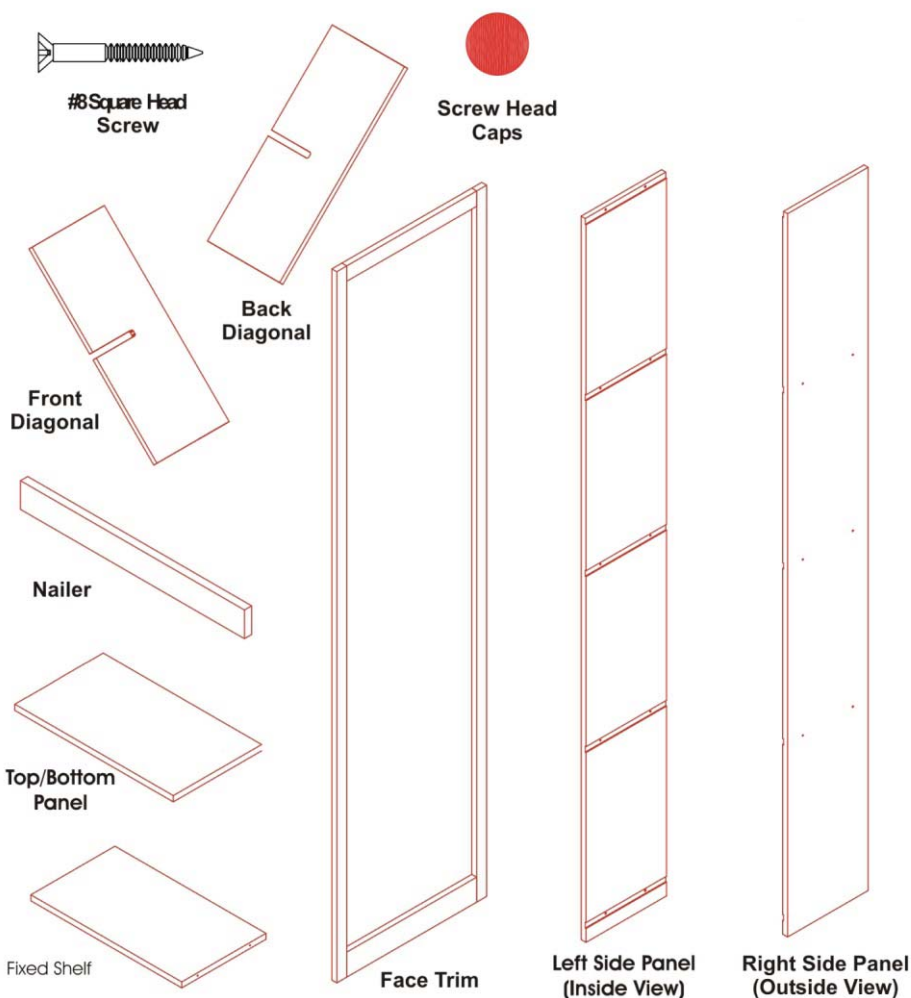

Classic Series (77 1/2" high)

- 2 Top/Bottom Panels (23 15/32" long)
- 2 Fixed Shelves (23 15/32" long)
- 2 Side Panels (77 1/2" long)
- 3 Back Diagonal Panels (32 1/8" long)
- 3 Front Diagonal Panels (32 1/8" long)
- 1 Top Face Frame (21 11/16" long)
- 1 Bottom Face Frame (21 11/16" long)
- 2 Side Face Frames (77 1/2" long)
- 20 #8 Square Head Screws (1 1/2" long)
- 16 Screw Head Caps
- 2 Nailers

Estate Series (92 1/2" high)

- 2 Top/Bottom Panels (21 9/32" long)
- 3 Fixed Shelves (21 9/32" long)
- 2 Side Panels (92 1/2" long)
- 4 Back Diagonal Panels (29" long)
- 4 Front Diagonal Panels (29" long)
- 1 Top Face Frame (19 1/2" long)
- 1 Bottom Face Frame (19 1/2" long)
- 2 Side Face Frames (92 1/2" long)
- 24 #8 Square Head Screws (1 1/2" long)
- 20 Screw Head Caps
- 2 Nailers

Parts List

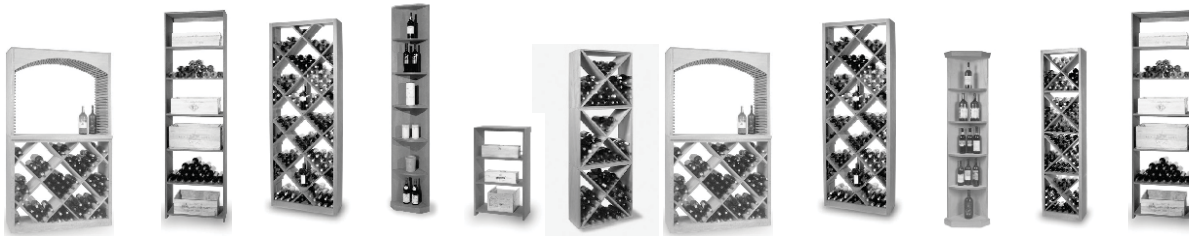

Tips: For Building Your Bins and Cases

Do not use a power drill when tightening your screws. If you do you could pierce the outside of the wood.

Before assembling your wine storage bin or case place a blanket down. You want a clean and scratch free surface during assembly.

It is recommended to use glue at joints when ever possible to make the joint stronger.

Pre-drill all screw holes with a 9/64" drill bit. This makes it less likely for your wood to split. (The easiest way to do this is to follow the pre-drilled holes provided on certain pieces as your guide.)

When assembling your case work make sure that all front edges are flush to one another.

Align the front of your case work to the front spacer bar of the adjacent racking. (This is true for every item except the Quarter Round, where you will line the filler strip up to the front of the spacer bar.)

When lining your case work up with adjacent racking, it may be pulled out slightly from the wall and therefore not able to be attached to a wall stud. We recommend securing it to the adjacent racking on both sides or purchasing L-Brackets from your hardware store to attach it to the wall.

When attaching your assembly to adjacent racking or other case work we recommend using clamps to hold the pieces together before securing with screws.

When attaching case work to racking, drill a hole through the side at a discrete location like the very top or below a shelf.

If you are attaching a 10 Column Soffit Arch above a Diamond Bin Table Base, it is recommended to not attach the outer face frame on the Diamond Bin Table Base. This will allow easy access to the diagonal panels for easy removal when attaching the arch through the top of the table base.

How to Care for Your Stained & Lacquered Wine Racks

Your Vigilant wine racks are built using the highest quality wood and finish available. When properly cared for, your wine racks will last longer than your finest bottles of wine. Here are a few tips on maintaining the quality and consistency of your racking.

Remove Dust: Dust build up from small airborne particles may scratch the surface if not removed correctly. Simply wipe the surface with a cloth dampened with a cleaning polish or mild detergent.

Clean: Fingerprints, cooking fumes, smoking residue, etc., accumulate on any surface. None of these contaminants will harm our Satin lacquer finish, but they should be periodically removed, to restore the finish to its original luster. Just wipe the surface with a cloth dampened with a non-wax containing polish or mild detergent solution. Avoid the use of ammonia based products or silicone oil, as they may cause damage if used over a long period of time.

Our Satin lacquer finish is durable and resistant to most household spills. However, spills should be wiped up promptly to avoid potential problems.

Excessive prolonged exposure to direct sunlight, high temperatures and high humidity can cause damage to both the finish and the wood itself. These should be avoided.

Following these simple steps will keep your finished wine racks looking like new for many years.

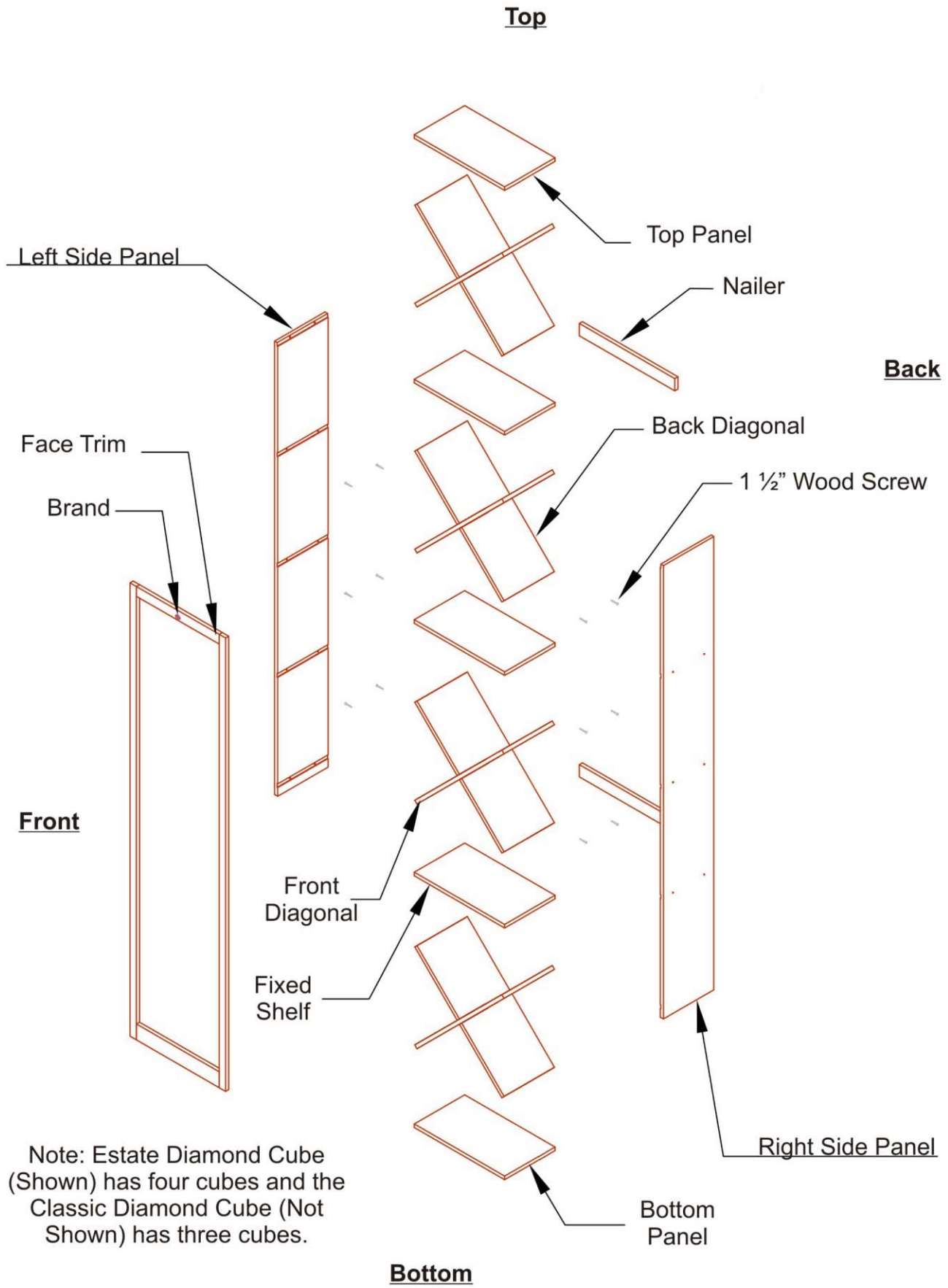

Note: Estate Diamond Cube (Shown) has four cubes and the Classic Diamond Cube (Not Shown) has three cubes.

Exploded View

Steps to Assembly

1. Locate the top, bottom and side panels (**See Parts List**).
2. Attach the top and bottom panels to the left side panel using the pre-drilled holes and screws provided (**Figure 1**).

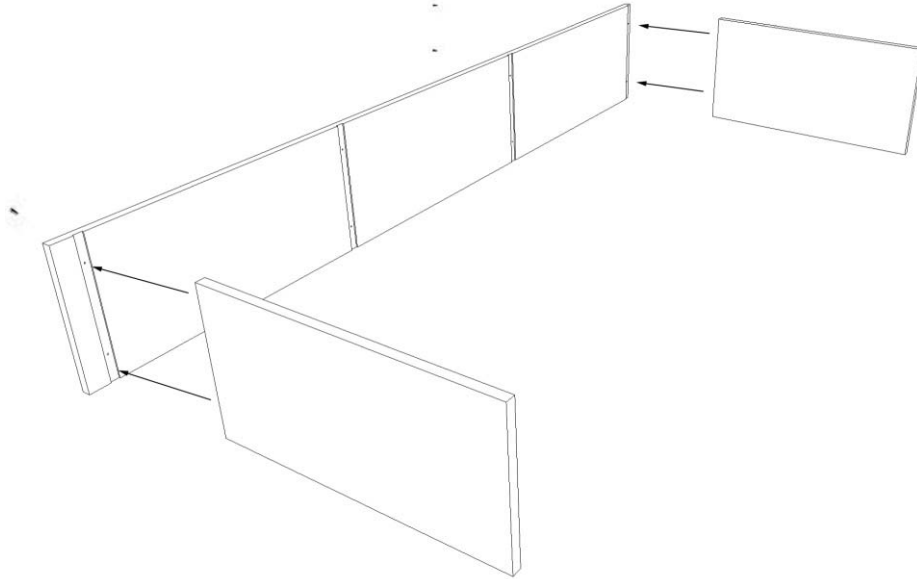

Figure 1

3. Attach the second side panel to the assembly using the pre-drilled holes and screws provided (**Figure 2**).

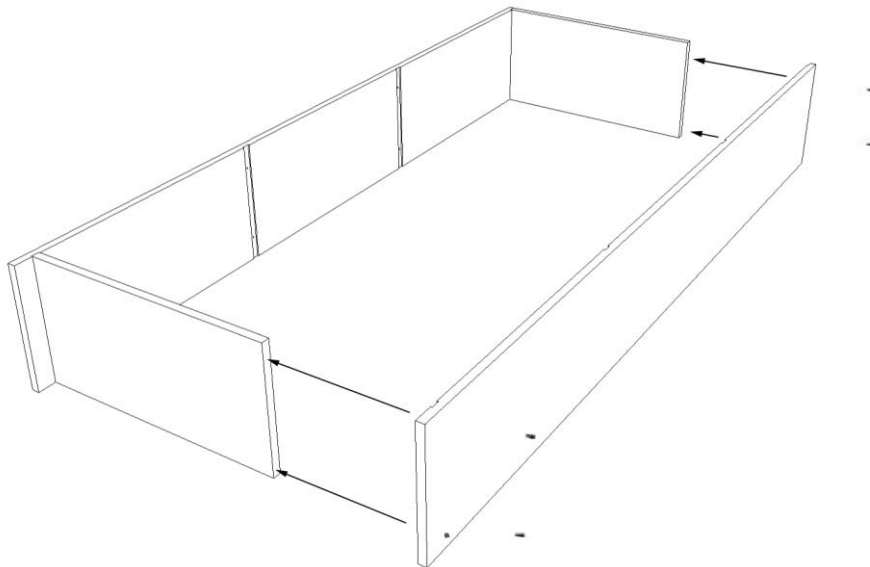

Figure 2

4. Your outer frame should be assembled and ready to stand upright. Your diamond cube should resemble **Figure 3**.

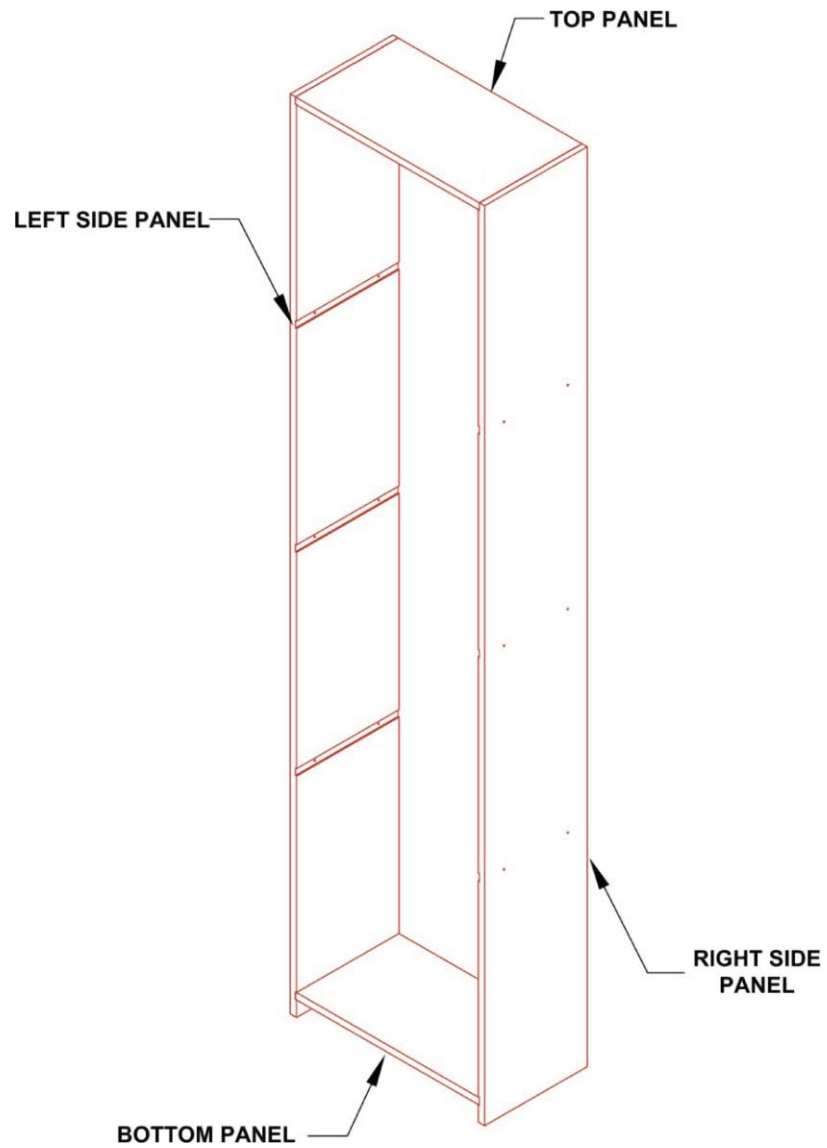

Figure 3

5. Locate your fixed shelves (there are (2) fixed shelves in the Classic Series and (3) in the Estate Series). Insert the shelves into the dados or slots then secure with the screws provided (**Figure 4**).

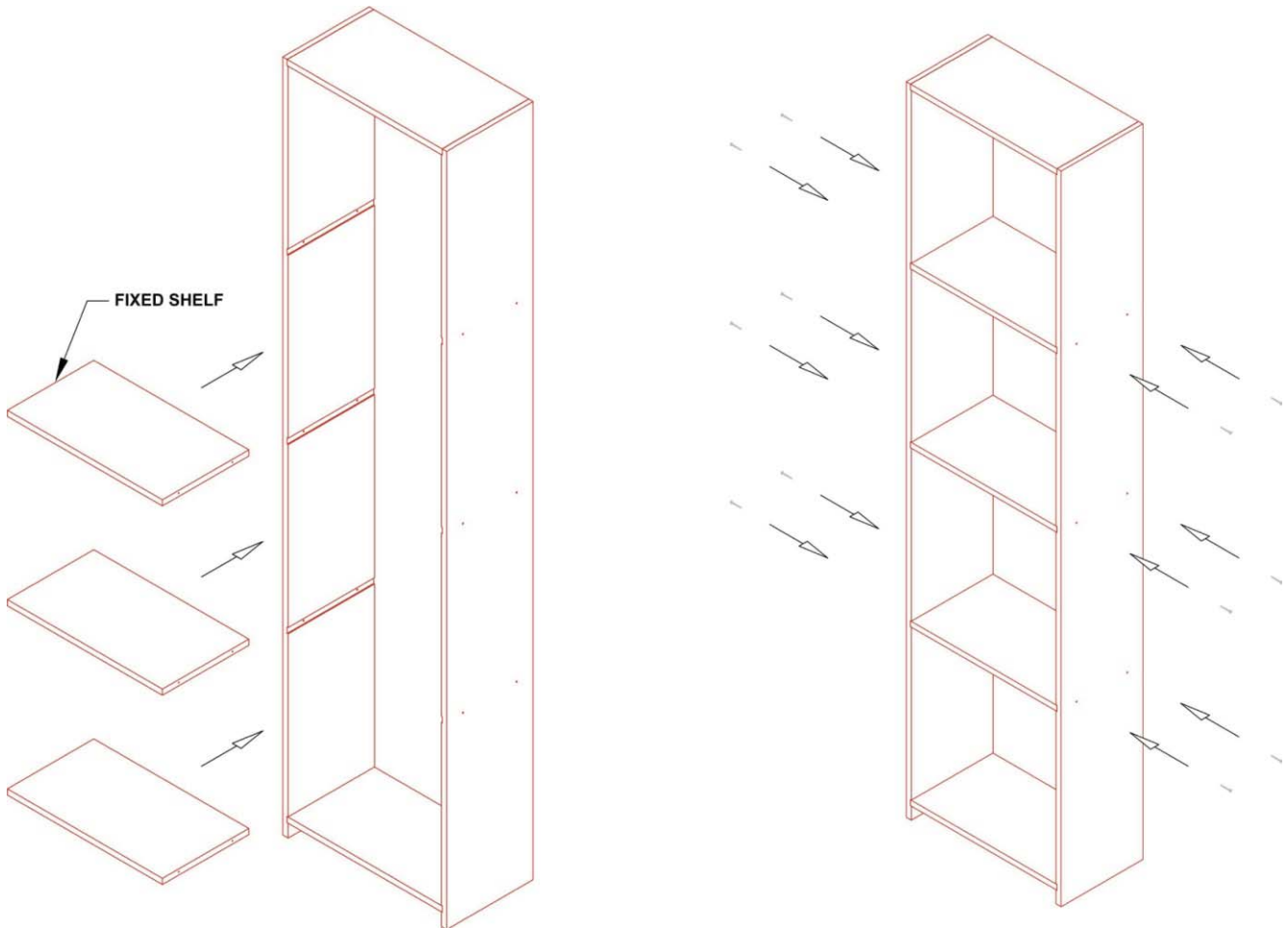
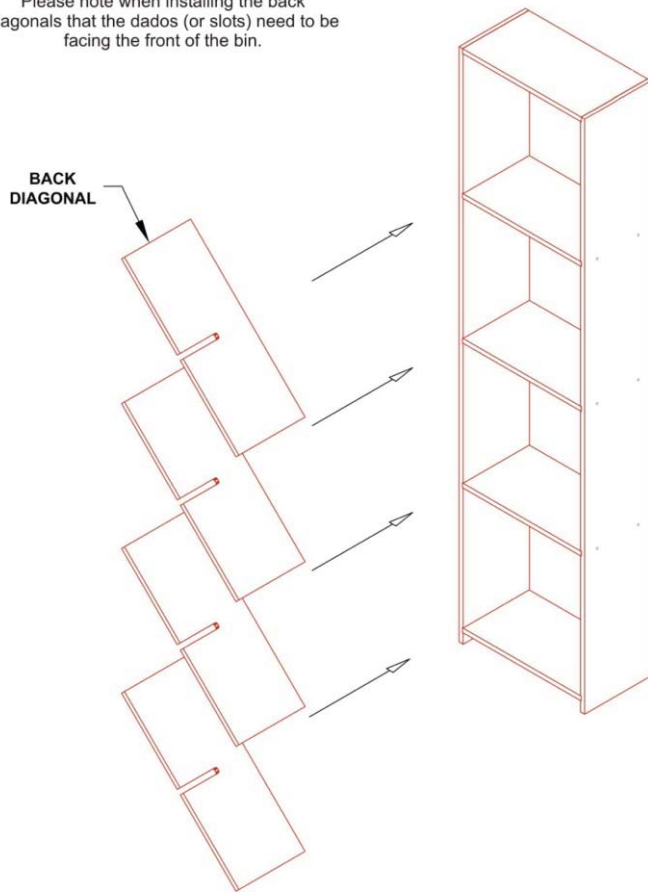

Figure 4

Please note when installing the back diagonals that the dados (or slots) need to be facing the front of the bin.



6. Insert one of your back panels into your first cube. Angle the panel from the upper left hand corner to the lower right hand corner. Make sure that the slot in the center of each panel is facing out, away from the assembly (**Figure 5**). Repeat for the remaining cubes.

Figure 5

7. Insert the remaining panels into the diamond cube. Angle the panel from lower left to upper right, fitting the slot in the center of the panel over the top of the slot in the back panel (**Figure 6**). (**Be sure to carefully align the edges of the inside panels so that they are flush with both the front and back edges of the side, top and bottom panels. You may use a soft-faced hammer here to ensure a proper fit.*)

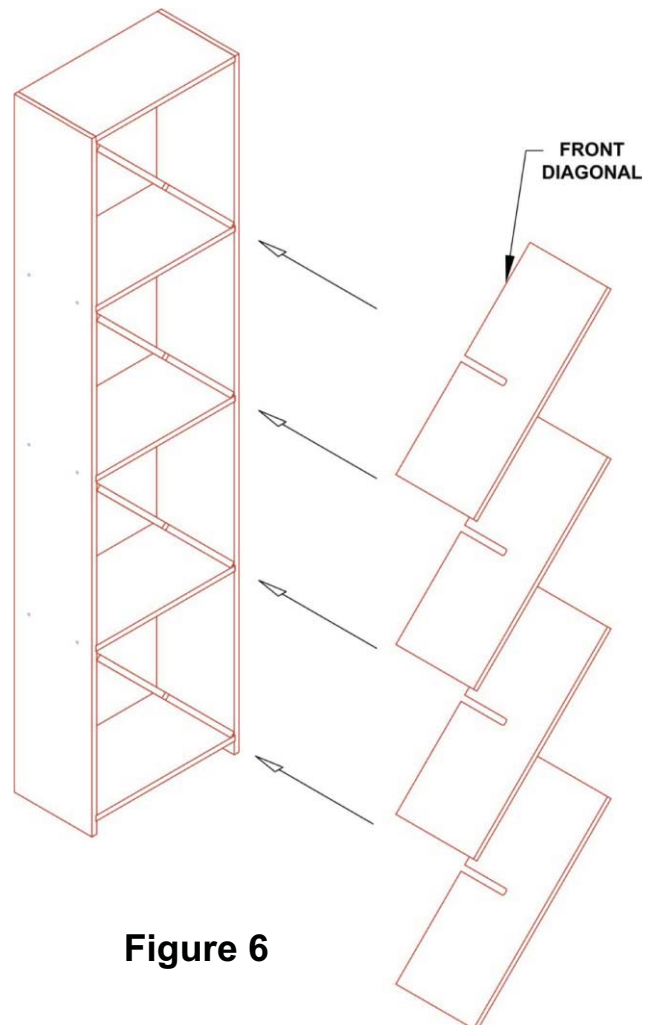

Figure 6

8. Locate your 2 nailers. Attach one nailer to the upper back of the diamond cube flush to the top using 4 #8 square head screws provided (**Figure 7**).
9. Repeating step 8, attach the second nailer to the lower back of the diamond cube flush to the bottom of the right and left panels (**Figure 7**).

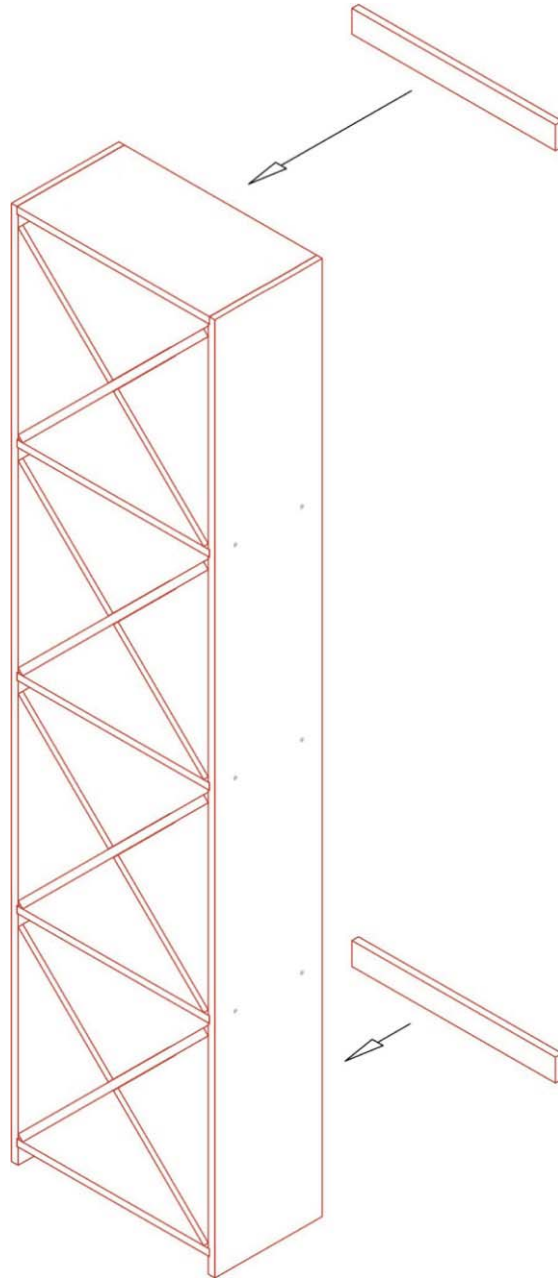

Figure 7

10. Locate your (4) face frame pieces. Take one of the long side pieces and line it up flush to the left side. Attach to the bin in several locations with finish nails (not provided). Repeat this step with your top frame (**Figure 8**). Be sure to have the Vigilant Brand facing forward.

Note: If you do not want the Vigilant Brand showing you can peel the emblem off. If there is any markings left from the emblem, reverse the top piece so that the emblem side is the attached side.

11. When attaching your bottom frame, be sure to have it flush with the floor and flush with the left piece of your face frame. Attach in the same manner that you have attached the previous frames.

12. Locate your right side frame. Make sure that this frame is flush with the top and bottom pieces. Attach the same way you attached the face frame in steps 10 and 11 (**Figure 8**).

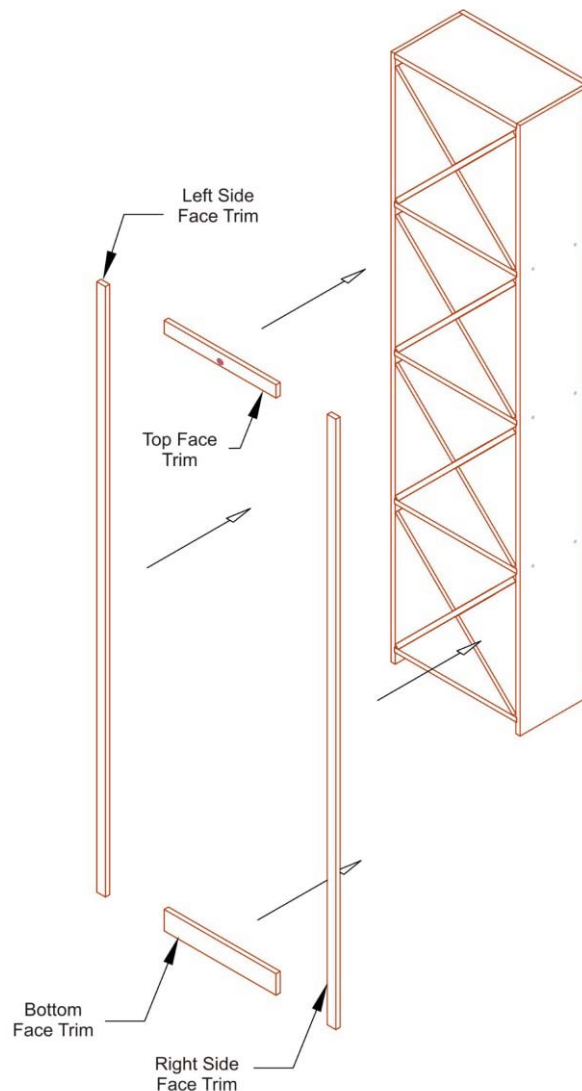

Figure 8

13. Place screw head caps onto the heads of all screws.

14. Your wine rack is now complete and ready to be moved to its final location. The rack should be placed with its back against a wall and be shimmed to level, front to back and side to side.

15. Attach your racking to the wall by drilling through the two nailers you attached at the top and bottom into two wall stud locations then fasten securely with wood screws (not provided).

***Failure to attach the rack to the wall could result in the rack tipping over. When fully loaded with wine your rack will weigh 375lbs. for the Classic Series and 400lbs. for the Estate Series.*

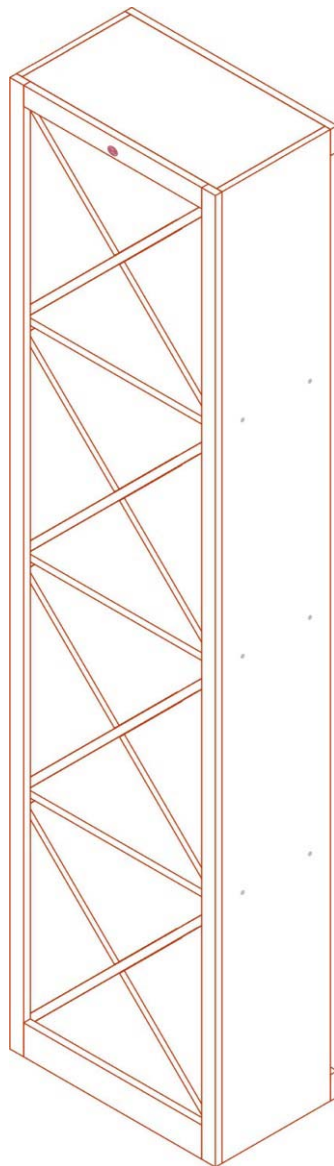

Finished Diamond Cube

Additional installation questions?
Contact us:



VIGILANT, INC.
85 Industrial Park Drive
Dover, NH 03820
Toll Free 1-888-812-4427
Outside US 1-603-285-0400
Fax 1-603-285-0420
email: info@vigilantinc.com
On the web www.vigilantinc.com